

# **G11A UTILITY CAR SERVICE MANUAL SUPPLEMENT**

---

## **FOREWORD**

This Supplement Service Manual has been prepared to introduce new service and new data for the G11A utility vehicle. For complete information on service procedures, it is necessary to use this Supplement Service Manual together with following manuals:

**G14A/G14E  
SERVICE MANUAL**

**G16A/G16E  
SERVICE MANUAL SUPPLEMENT**

**G11A  
SERVICE MANUAL SUPPLEMENT  
1999 by Yamaha Motor Manufacturing  
Corporation of America  
2nd edition, June 1999  
Printed in U.S.A.  
P/N/ LIT-19616-00-00**



---

# INTRODUCTION

This manual has been written by Yamaha Motor Manufacturing Corporation of America for use by Authorized Yamaha dealers and their qualified mechanics. It is not possible to put an entire mechanic's education into a manual, so it is assumed that persons using this book to perform maintenance and repairs on Yamaha golf cars have a basic understanding of the mechanical concepts and procedures inherent to these products. Without such knowledge, attempted repairs or service to this golf car may render it unfit to use and/or unsafe.

Yamaha Motor Manufacturing Corporation of America is continually striving to further improve all models manufactured by the company. Modifications are therefore inevitable and will, where applicable, appear in future editions of this manual.

**TECHNICAL SERVICE DEPT  
GOLF CAR SALES GROUP  
YAMAHA MOTOR  
MANUFACTURING CORP OF  
AMERICA**

## HOW TO USE THIS MANUAL

### Read This Important Information!

Particularly important information in this manual is distinguished by the following notations:



The Safety Alert Symbol means **ATTENTION! BE ALERT! YOUR SAFETY IS INVOLVED!**

#### **! WARNING**

**Failure to follow WARNING instructions could result in severe injury or death to golf car occupants, a bystander, or a person inspecting or repairing the golf car.**

#### **CAUTION**

**This message describes special precautions that must be taken to avoid damage to the golf car.**

#### **NOTE:**

This message provides additional key information.

### MANUAL FORMAT

All of the procedures in this manual are organized in a sequential, step-by-step format. The information has been compiled to provide the mechanic with an easy to read, handy reference that contains comprehensive explanations of all disassembly, repair, assembly, and inspection operations.

In this revised format, the condition of a faulty component will precede an arrow symbol and the course of action required will follow the symbol, e.g.,

- Bearings  
Pitting/Damage → Replace.

### EXPLODED DIAGRAM

Each chapter provides exploded diagrams before each disassembly section for ease of identifying correct disassembly and assembly procedures.

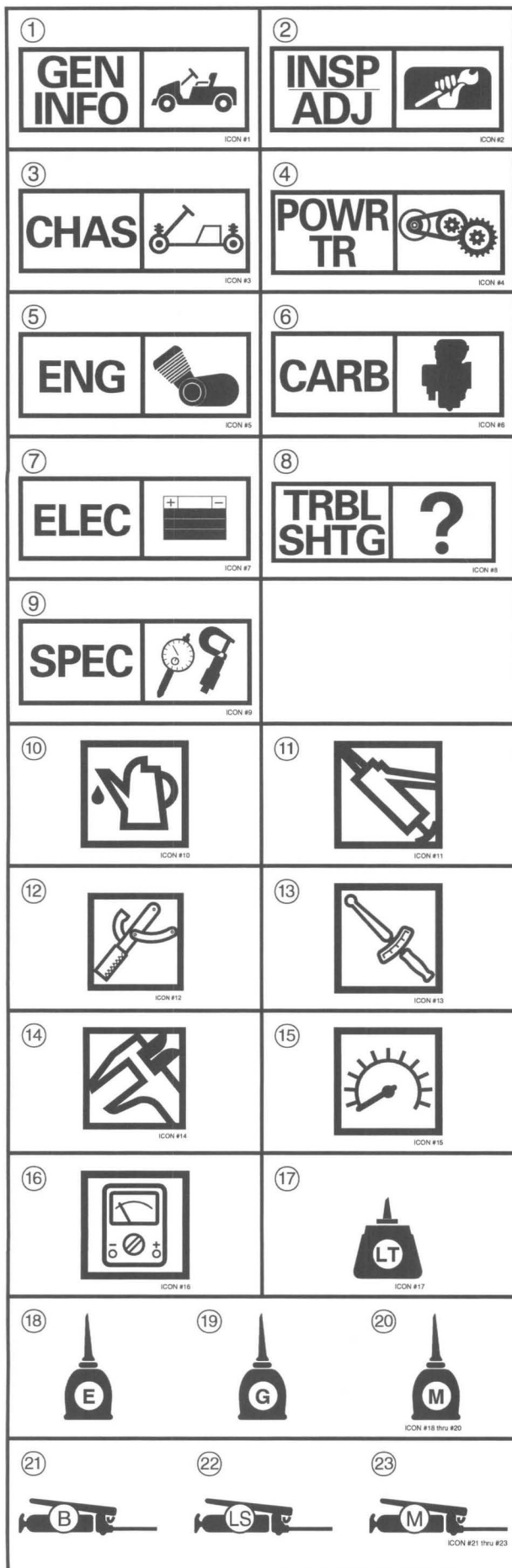

## Symbol Identification

Symbols ① to ⑨ are designed as thumb tabs to indicate the contents within a chapter.

- ① General information
- ② Periodic inspection and adjustment
- ③ Chassis
- ④ Power train
- ⑤ Engine overhaul
- ⑥ Carburetion
- ⑦ Electrical
- ⑧ Troubleshooting
- ⑨ Specifications









Symbols ⑩ to ⑯ are used to identify specifications within the text.

- ⑩ Filling fluid
- ⑪ Lubricant
- ⑫ Special tool
- ⑬ Tightening torque
- ⑭ Wear limit, clearance
- ⑮ Engine speed
- ⑯  $\Omega$ , V, A

Symbols ⑰ to ㉓ are used in the exploded diagrams to indicate the grade and location of lubricant.

- ⑰ Apply locking agent
- ⑱ Apply engine oil
- ⑲ Apply gear oil
- ㉑ Apply molybdenum disulfide oil
- ㉒ Apply wheel bearing grease
- ㉓ Apply lightweight lithium soap base grease
- ㉔ Apply molybdenum disulfide grease

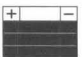
# INDEX

<b>GENERAL INFORMATION</b>	(Refer to G16A/E Service Manual Supplement)	 <b>GEN INFO 1</b>
<b>PERIODIC INSPECTION AND ADJUSTMENT</b>	(Refer to G16A/E Service Manual Supplement)	 <b>INSP ADJ 2</b>
<b>CHASSIS</b>	(Refer to G14A, G14E Service Manual)	 <b>CHAS 3</b>
<b>POWER TRAIN</b>	(Refer to G16A/E Service Manual Supplement)	 <b>POWR TR 4</b>
<b>ENGINE OVERHAUL</b>	(Refer to G16A/E Service Manual Supplement)	 <b>ENG 5</b>
<b>CARBURETION</b>	(Refer to G16A/E Service Manual Supplement)	 <b>CARB 6</b>
<b>ELECTRICAL</b>	(Refer to G16A/E Service Manual Supplement)	 <b>ELEC 7</b>
<b>TROUBLESHOOTING</b>	(Refer to G14A, G14E Service Manual)	 <b>TRBL SHTG 8</b>
<b>SPECIFICATIONS</b>		 <b>SPEC 9</b>

---

## TABLE OF CONTENTS

### CHAPTER 2 – PERIODIC INSPECTION AND ADJUSTMENT

MAINTENANCE CHART .....	2-1
-------------------------	-----

### CHAPTER 9 – SPECIFICATIONS

SPECIFICATIONS .....	9-1
GENERAL SPECIFICATIONS .....	9-1
CABLE/WIRE ROUTING for G11A .....	9-2
TOWBAR .....	9-4
EMISSION CONTROL SYSTEM .....	9-5



## PERIODIC INSPECTION AND ADJUSTMENT

### PERIODIC MAINTENANCE

Regular maintenance is most important for best performance and safe operation.

#### **⚠ WARNING**

**Be sure to turn off the main switch and apply the parking brake when you perform maintenance unless otherwise specified.**

#### FOR G11A

C - CHECK CA - CHECK AND ADJUST R - REPLACE S - SERVICE CL - CLEAN AND LUBRICATE L - LUBRICATE

	Remarks	Pre-Operation	20 Rounds 20 hours 100 miles 160 kms (Every month)	125 rds 125 hrs 600 mls 1000 kms (Every 6 months)	250 rds 250 hrs 1200 mls 2000 kms (Every year)	500 rds 500 hrs 2500 mls 4000 kms (Every 2 years)	1000 rds 1000 hrs 5000mls 8000 kms (Every 4 years)
PRE-OPERATION CHECKS	Check engine oil	C	C	C			
	Check air cooling duct	C	C	C	C	C	C
	Check fuel lines for leakage	C	C	C	C	C	C
	Check fuel level	C	C	C	C	C	C
	Check for looseness and corrosion of battery terminals and hold downs	C	C	C	C	C	C
	Check brake pedal freeplay and adjust if necessary	C	CA	CA	CA	CA	CA
	Check steering operation	C	C	C	C	C	
	Check tire pressure, tread depth, tire surface for damage	C	CA	CA	CA	CA	CA
	Check body and chassis for damage	C	C	C	C	C	C
	Check tightness of all bolts, nuts, and screws	C	C	C	C	C	C
	Check reverse buzzer operation	C	C	C	C	C	C
EVERY MONTH	Check fuel filter for clogging		C	C	C	C	C
	Check wear of drive belt		C	C	C	C	C
	Check operation of Forward / Reverse shifting		C	C	C	C	C
	Clean / Lube pedal control area		CL				
EVERY 6 MONTHS	Wash pre-filter, check air cleaner element			S	S	S	S
	Check spark plug and plug cap condition** / Check compression			C	C	C	C
	Check shock absorbers for oil leaks and damaged springs			C	C	C	

\*\*Related to emission control system.



**C - CHECK   CA - CHECK AND ADJUST   R - REPLACE   S - SERVICE   CL - CLEAN AND LUBRICATE   L - LUBRICATE**

	Remarks	Pre-Operation	20 Rounds 20 hours 100 miles 160 kms (Every month)	125 rds 125 hrs 600 mls 1000 kms (Every 6 months)	250 rds 250 hrs 1200 mls 2000 kms (Every year)	500 rds 500 hrs 2500 mls 4000 kms (Every 2 years)	1000 rds 1000 hrs 5000mls 8000 kms (Every 4 years)
EVERY YEAR	Replace engine oil				R	R	R
	Adjust throttle cables,** choke cable, check carburetor throttle shaft for wear**				CA	CA	CA
	Check starter V-belt for damage and tension				C	C	C
	Check drive belt for slippage, wear or scratches				C	C	C
	Check sliding sheave and ramp shoes; Grease secondary sheave bearing.				CL	CL	CL
	Grease primary sheave				L	L	L
	Check operation of speed limiter				C	C	C
	Apply battery terminal protectant				S	S	S
	Check wiring connections and insulation				C	C	C
	Check shoe lining thickness and rear axle bearing play				C	C	C
	Check kingpin play, seal, and cap / Adjust wheel alignment				CA	CA	CA
	Check wheel nut tightness, front wheel bearing play				C	C	C
	Check gear box oil level and leakage				C	C	C
	Check operation and adjust pedal stop if necessary				CA	CA	CA
EVERY 2 YEARS	Check brushes for wear and commutator for dirt					C	S
EVERY 4 YEARS	Replace fuel filter and fuel hoses						R
	Check tightness of cylinder head / Adjust valves						CA
	Replace gear box oil						R
	Check for grease leakage; adjust gearbox if necessary						CA

\*\*Related to emission control system.





## SPECIFICATIONS

### GENERAL SPECIFICATIONS

Item	Model	G11A
Model Code: Frame Serial Number		JR31 JR3-000101 ~
Dimensions: Overall Length Overall Width Overall Height (Steering height) Height of Floor Wheelbase Tread: Front Rear Min. Ground Clearance		3050 mm (120.08 in) 1280 mm (50.4 in) 1200 mm (47.2 in) 300 mm (11.8 in) 1900 mm (74.8 in) 870 mm (34.3 in) 980 mm (38.6 in) 115 mm (4.5 in)
Weight: Dry Weight (without battery)		380 kg (837.8 lb)
Performance: Maximum Speed Minimum Turning Radius Seating Capacity Hill Climbing Ability		19-24 km/h (12-15 mph) 3.5 m (137.8 in) 2 persons 27° on pavement



## CABLE/WIRE ROUTING FOR G11A

- |                                 |                                    |
|---------------------------------|------------------------------------|
| ① Main switch wire              | ⑦ Positive cable                   |
| ② Pilot lamp (oil warning) wire | ⑧ Plus lead to starter generator   |
| ③ Stop switch wire              | ⑨ To reverse buzzer switch         |
| ④ Accelerator cable             | ⑩ Pulse hose to fuel pump          |
| ⑤ Brake cables                  | ⑪ Throttle cable Z to transmission |
| ⑥ Negative cable                | ⑫ Reverse buzzer                   |

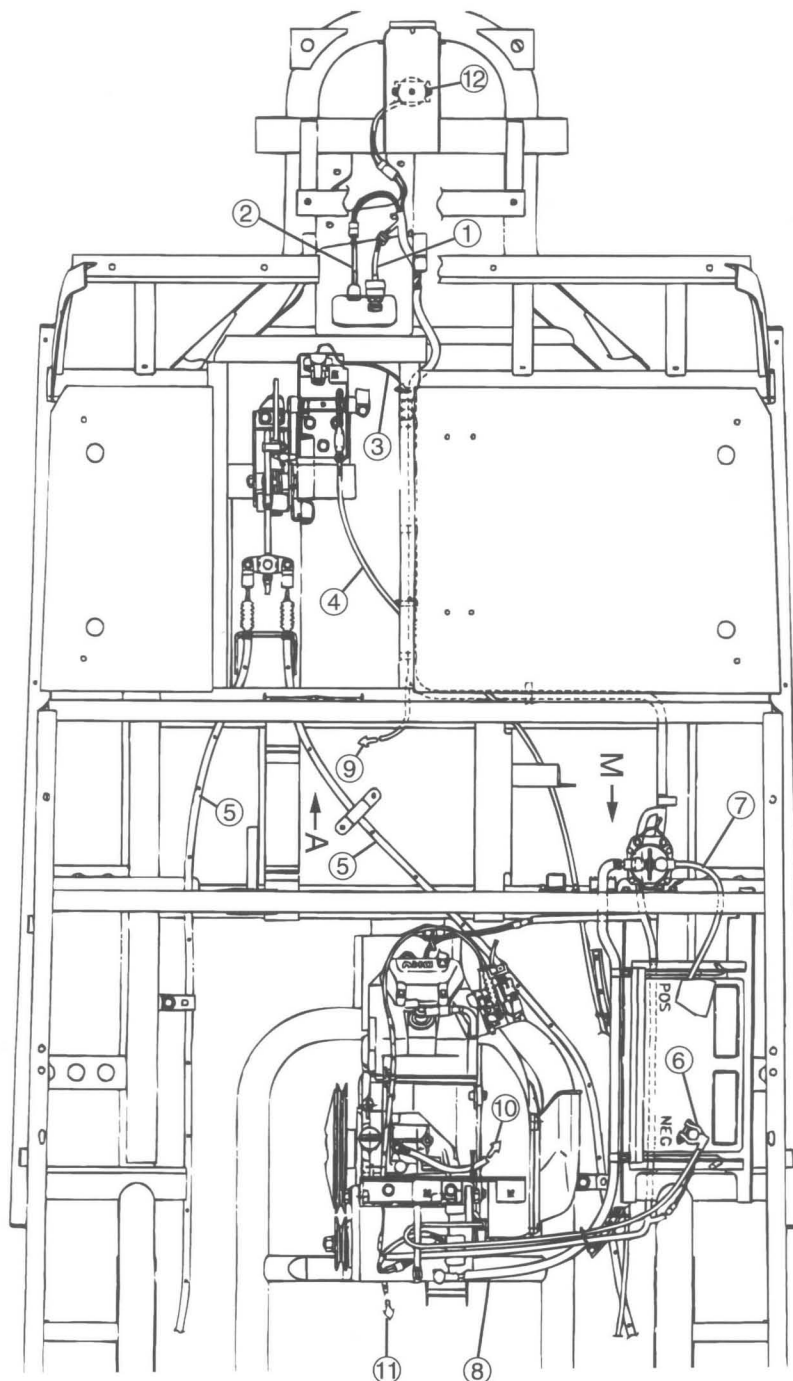

Y-845



- ① Fuel pump pulse hose
- ② Fuel pump delivery hose
- ③ Fuel hose to carburetor
- ④ Relay positive cable
- ⑤ Relay lead wires
- ⑥ Relay negative cable
- ⑦ Reverse buzzer switch
- ⑧ Frame
- ⑨ Wire harness lead
- ⑩ Engine stop relay
- ⑪ Voltage regulator
- ⑫ Relay wire haness
- ⑬ Ground lead
- ⑭ Solenoid relay

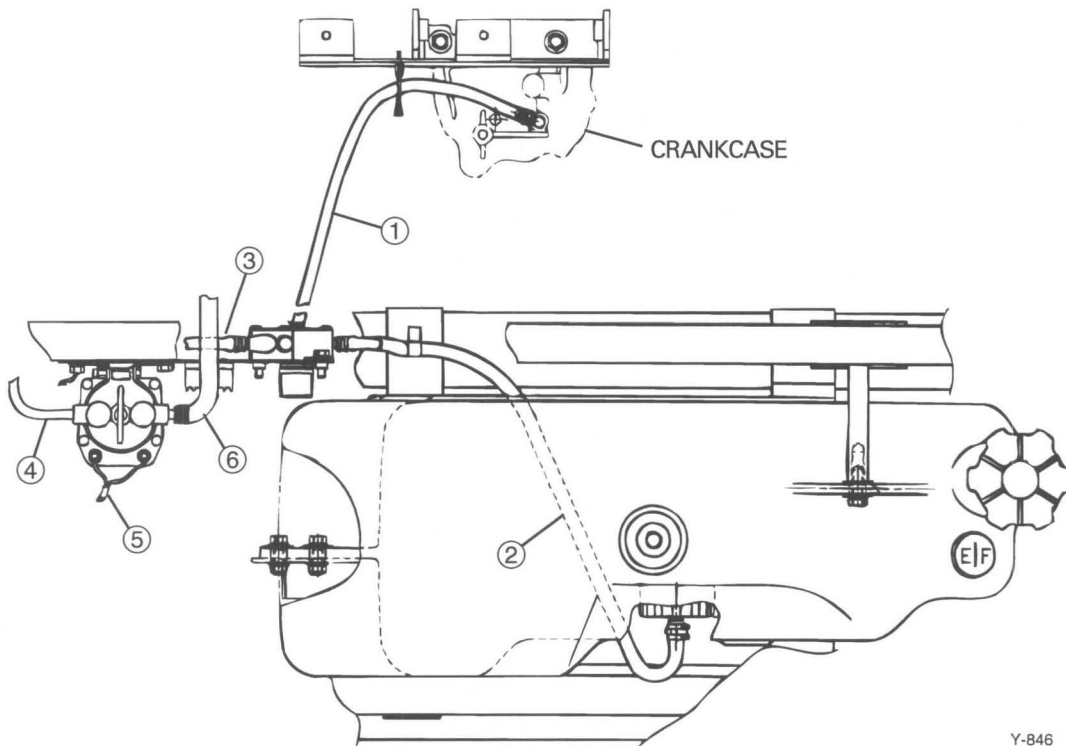

Y-846

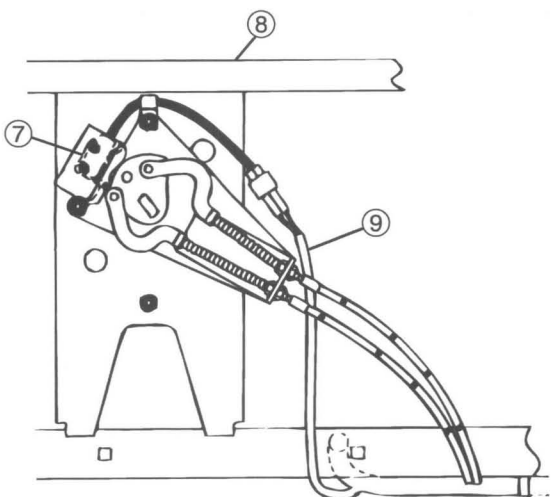

Y-847

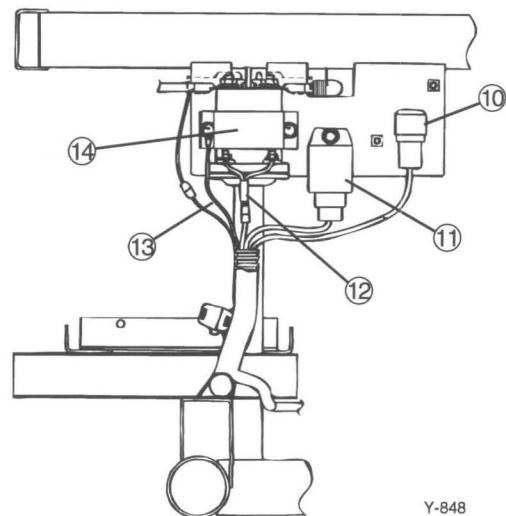

Y-848



- ① Towbar U-bolt torque: 23 ft lb (315 kgf.cm, 3.1 Nm)
- ② Centering distance =  $114.5 \pm 2.0$  mm

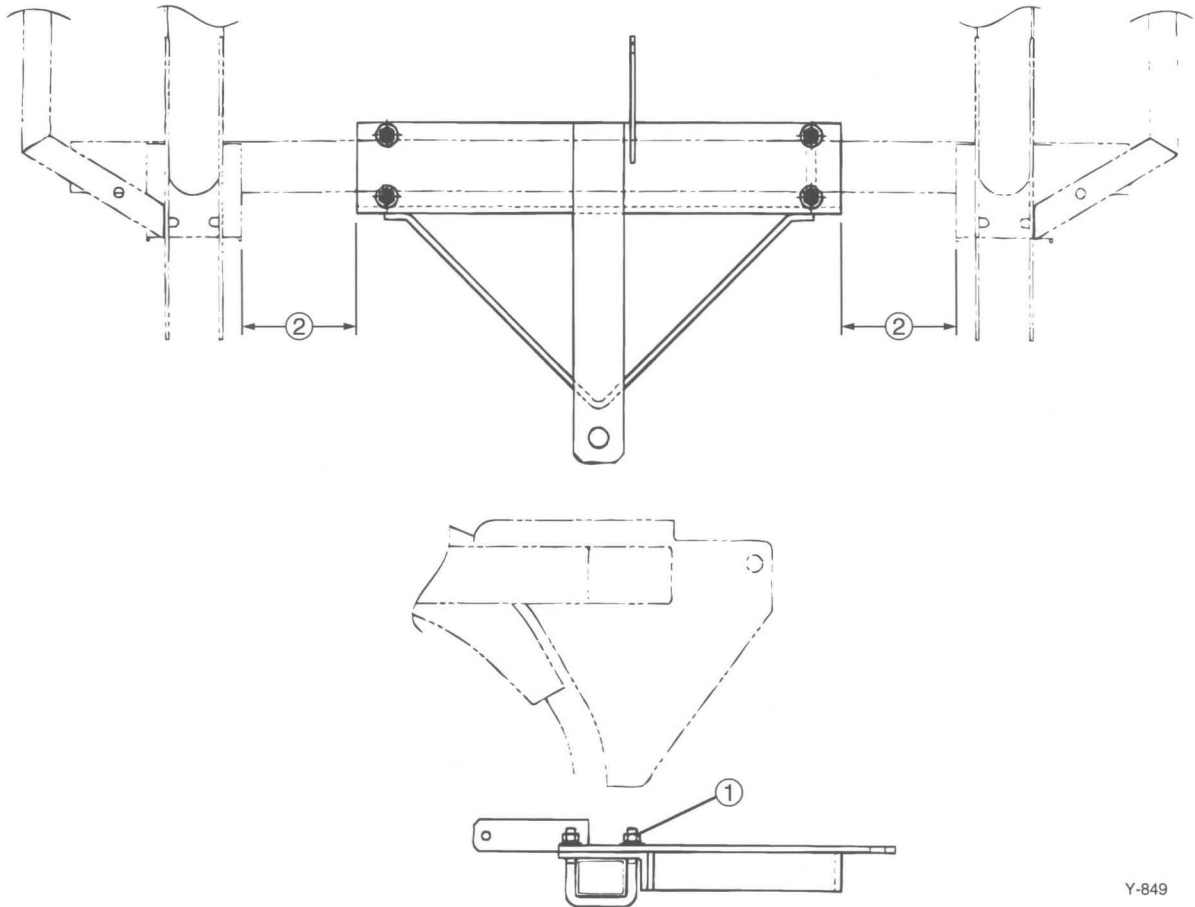

Y-849

**EMISSION CONTROL SYSTEM COMPONENTS**

- ① Air cleaner
- ② Crankcase breather hose
- ③ Engine
- ④ Carburetor
- ⑤ TCI Magneto
- ⑥ Exhaust

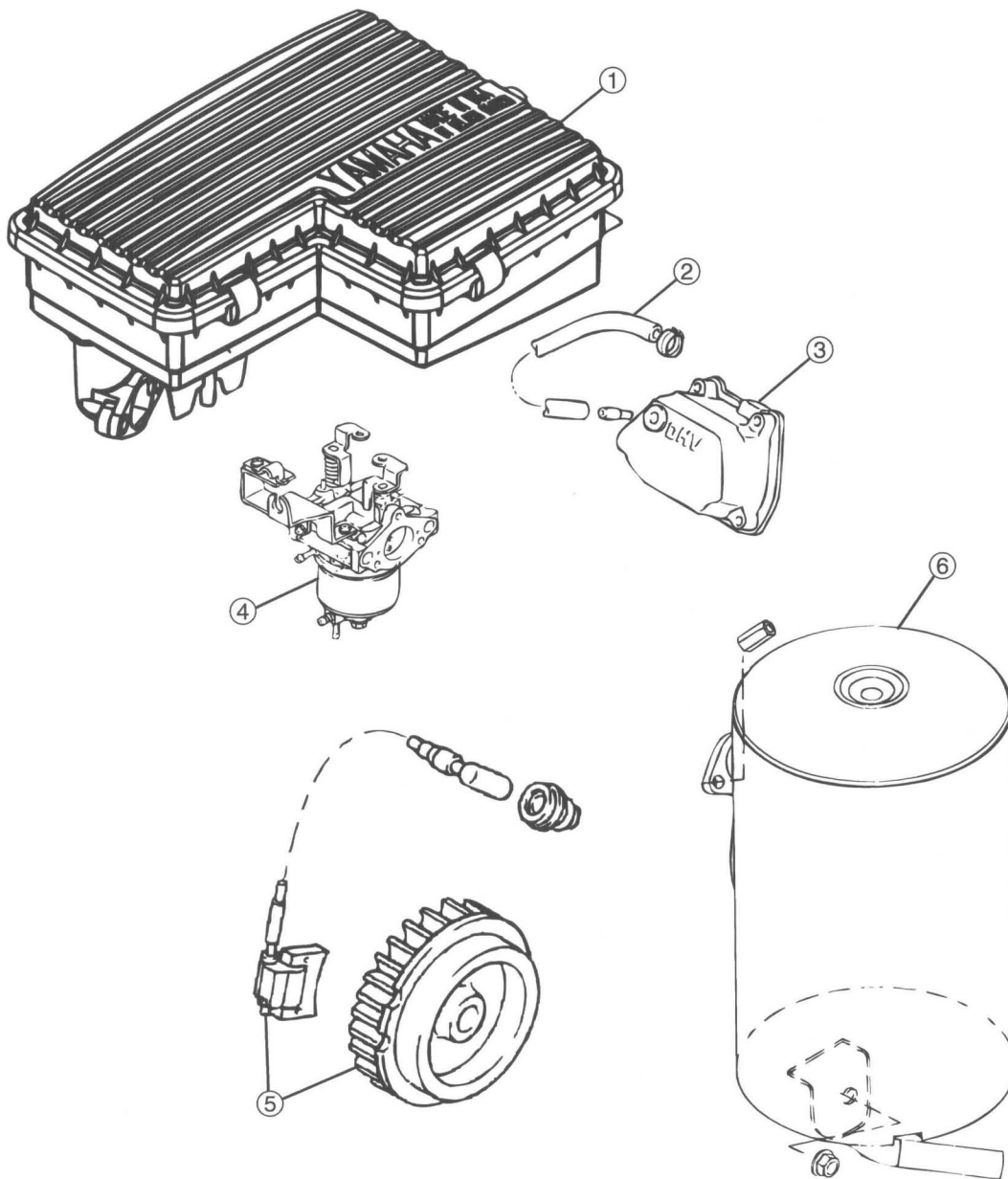

Y-844

